

TT-8D-N



Pre-made pouch
filler/sealer



Pro Mach Flexible
Packaging Group

650 Dekora Woods Blvd.
Saukville, WI 53080

(888) 628-7491
(262) 268-8300

Info@ProMachFlexible.com
www.ProMachFlexible.com

FEATURES & BENEFITS

- Widely flexible for various pouch formats and product types.
- Designed for safe and sanitary operation.
- Easy cleaning, wash down design.
- Simple, intuitive operation and maintenance using touch screen controls.
- Optional zipper opening, nitrogen gas flush, liquid filling systems and other features.

Conveyor Magazine

Stand-up and pouches with
press-to-close.



Color Touch Screen

Simplified graphic panel for user-friendly
operation and maintenance.



powered by Pro Mach

TT-8D-N



MACHINE SPECIFICATIONS

Pre-made pouch
filler/sealer

Capacity	55 pouches/min./max. (Depending on product)	
Pouch Size	<ul style="list-style-type: none"> Width 120 - 260 mm (80 - 220 mm) Length 130 - 400 mm 	
Pouch Material	Various laminated pouches, PE pouch	
Pouch Style	<ul style="list-style-type: none"> Flat Stand-up Press-to-close 	
Sealing Method	1 heat seal and 1 cooling station	
Electric Power	4.5 kw	
Air Consumption	0.5 MPa (72 psi), 350 - 450 NI/min. (Depending on machine spec)	
Machine Dimensions	1,800 (W) x 2,507 (L) x 2,040 (H) mm	
Machine Weight	1,700 kg	
Accessories	<ul style="list-style-type: none"> Product feeding hopper Product discharge conveyor 	<ul style="list-style-type: none"> Pouch opening follow-up guide Product counter
Options	<ul style="list-style-type: none"> Date printer Air squeeze device Tapping Stand-up pouch bottom opening device 	<ul style="list-style-type: none"> N2 gas flush device Zip open-close device Fill pause mode Seal area cleaning Pouch recycle

APPLICATIONS

- Frozen foods
- Seafood
- Snacks
- Rice & other grains
- Noodles
- Pet foods
- Granular & powder products
- Many others!

MACHINE DIMENSIONS

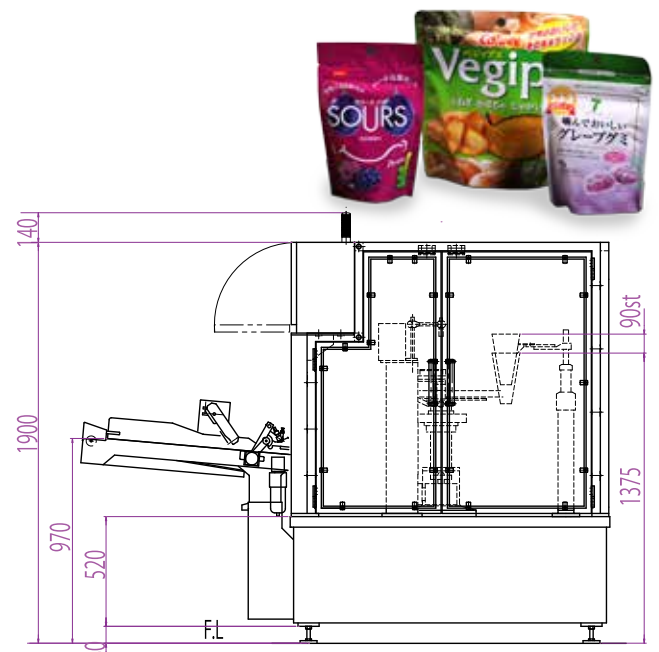
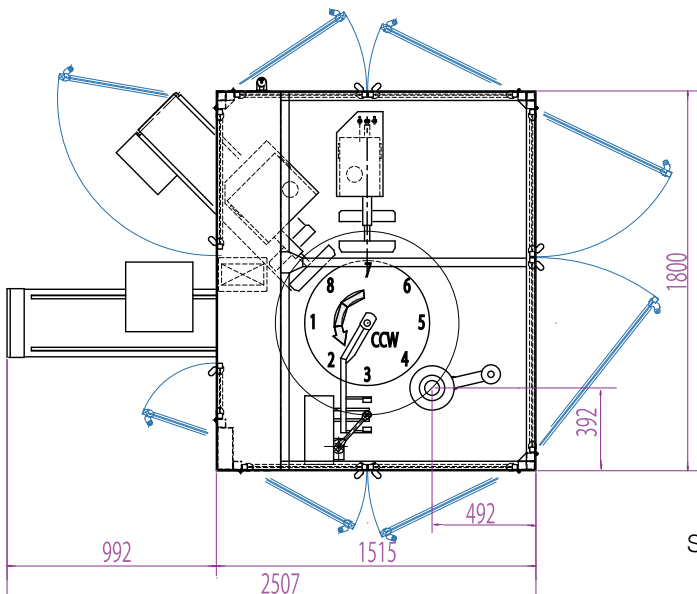

Specifications and dimensions are subject to change without prior notice, due to continuous efforts made for product improvement.